

TECHNICAL RECOMMENDATIONS:

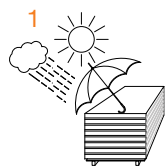

1. Protect the sheets from the sun and rain

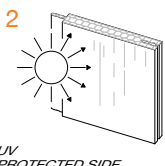

UV PROTECTED SIDE

2. Install the sheets always with the UV protected layer facing outwards



3. Multiwall polycarbonate sheets **can not be walked upon**

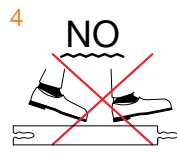

4. Do not walk onto the sheets at any time. Follow safety regulations and safe methods of installation

Polycarbonate may suffer a chemical attack from some products therefore:



NO
BITUMINOUS
OR TAR JOINTS

5. Use **only compatible clear silicone** for the sealing

6. Use **only water and mild detergents** for cleaning

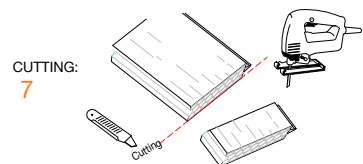

CUTTING:
7

7. Cutting of the sheets can be executed on site by the means of a hack sawing machine (1) or of a cutter (2). **Seal the open cells after cutting.**

PROTECTIVE FILM:

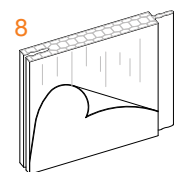

8

SEALING:

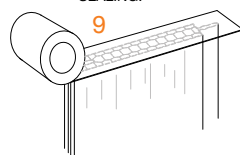

9

8. Take off the protective film before the installation.

9. Seal the open cells with an adhesive aluminium tape.

10. Protect the sealing with an upper and lower profile flashing

10a) Lower profiles must be drilled for water draining.

PROFILES:

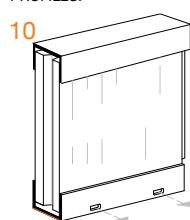

10

LOADINGS AND SPACING:

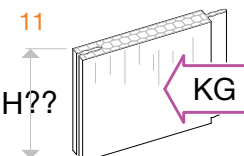

H??

10.a

11. Loading and Spacings - Check our technical literature to determine loading and spacing of the whole system



KG

panelPIU

polyPIU
AUSTRALIA
SOLUTIONS IN POLYCARBONATE

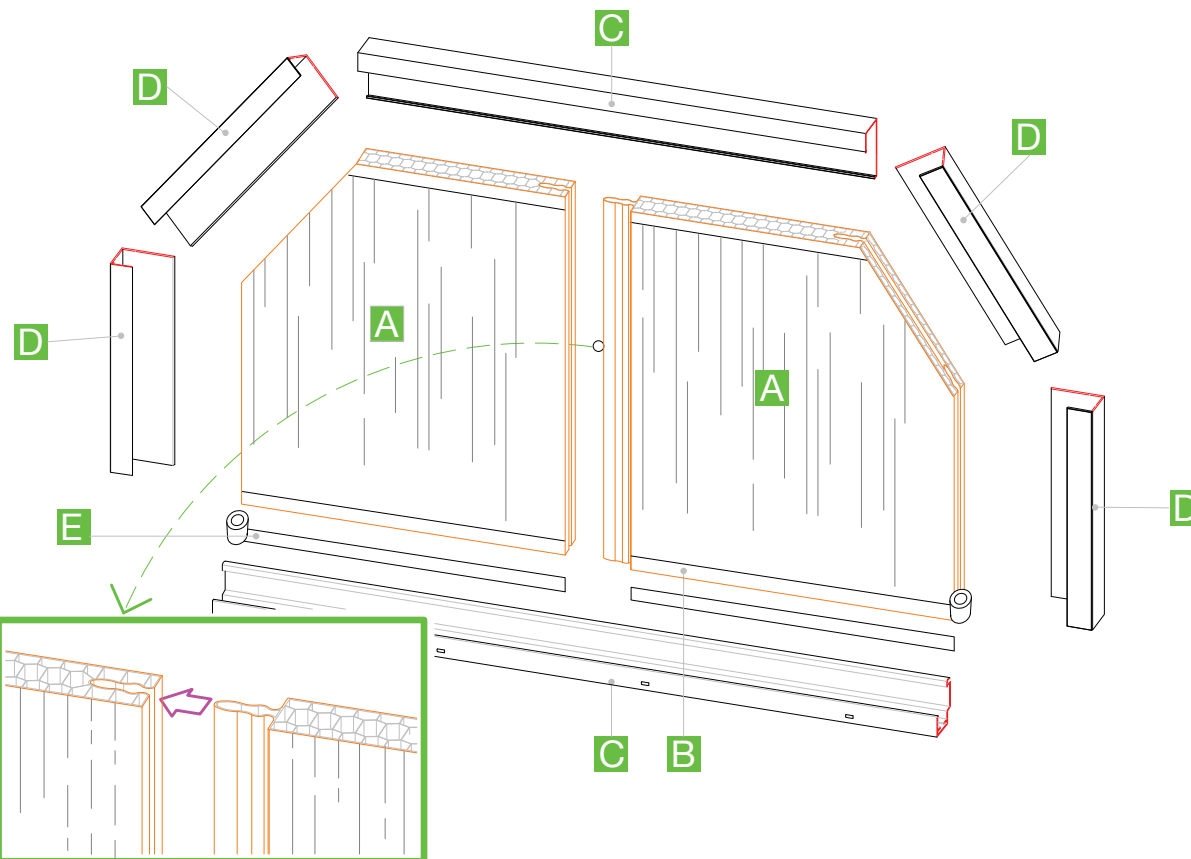

A PANELPIU' 500

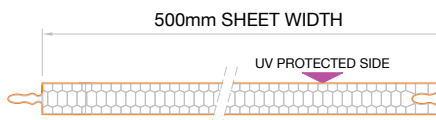

B SEAL TAPE

C TOP / BOTTOM FLASHING

D SIDE FLASHING

E DOUBLE-SIDED TAPE